

Model	qty (C282LED)	Power	N.W.	Products Size (Cut out)
Aries	5	5x3W	6.3 Kg	L600xW600xH60mm (L550xW550mm)
Taurus	10	10x3W	6.8 Kg	
Gemini	17	17x3W	7.6 Kg	
Cancer	6	6x3W	6.4 Kg	
Leo	9	9x3W	6.7 Kg	
Virgo	13	13x3W	7.2 Kg	
Libra	9	9x3W	6.7 Kg	
Scorpio	14	14x3W	7.3 Kg	
Sagittarius	21	21x3W	8 Kg	
Capricorn	12	12x3W	7 Kg	
Aquarius	13	13x3W	7.2 Kg	
Pisces	20	20x3W	7.9 Kg	

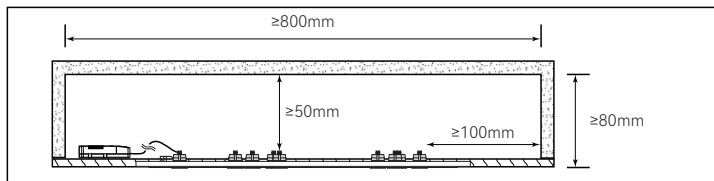

To secure safety, a qualified electrician is required to install/remove the luminaire, in according with IEEE regulation and installation instructions.



CAUTION: Electric Shock.....



Don't stare at the operating light source.....



CAUTION: the luminaire must not be disposed of with household waste.....

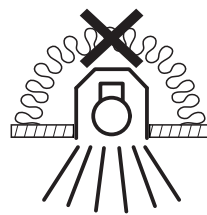

Luminaire not suitable for covering with thermally insulating material.

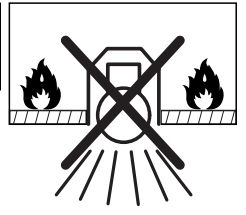

Luminaire can't recessed mounted into flammable material.

Aries

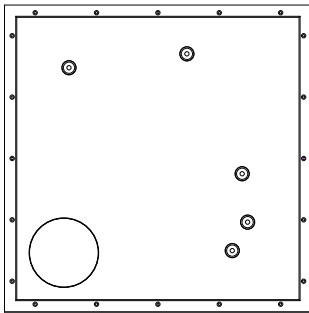

Taurus

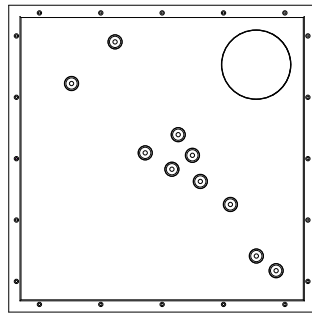

Gemini

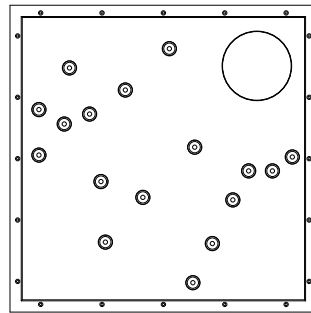

Cancer

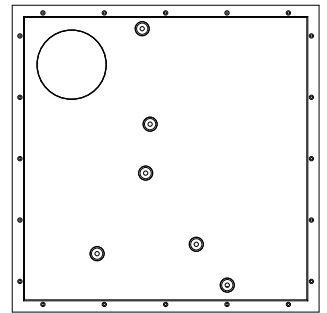

Leo

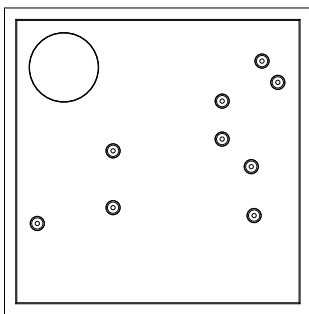

Virgo

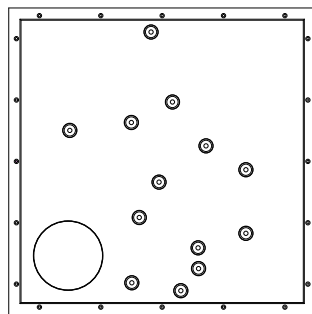

Libra

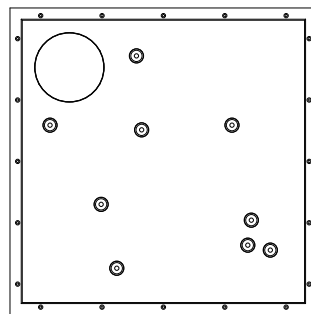

Scorpio

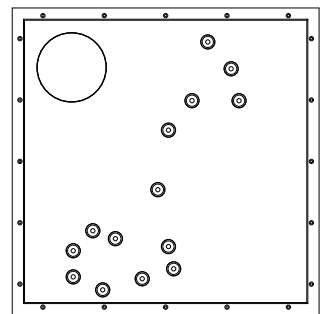

Sagittarius

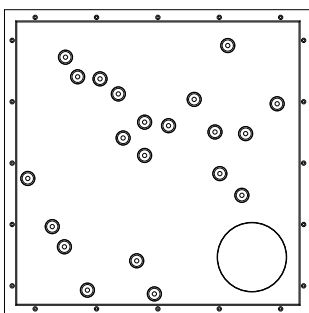

Capricorn

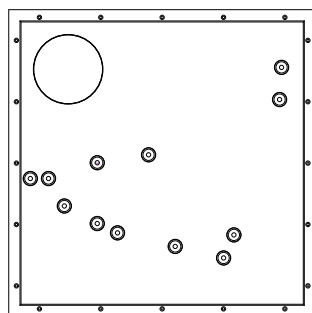

Aquarius

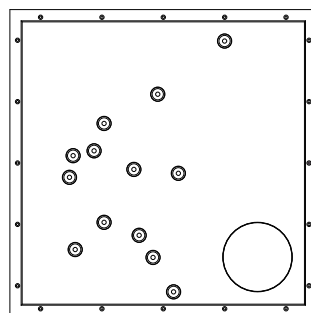

Pisces

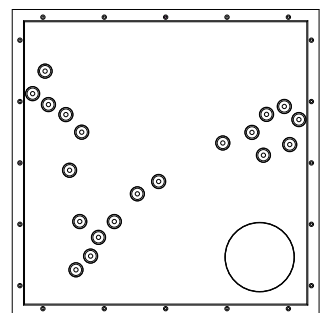

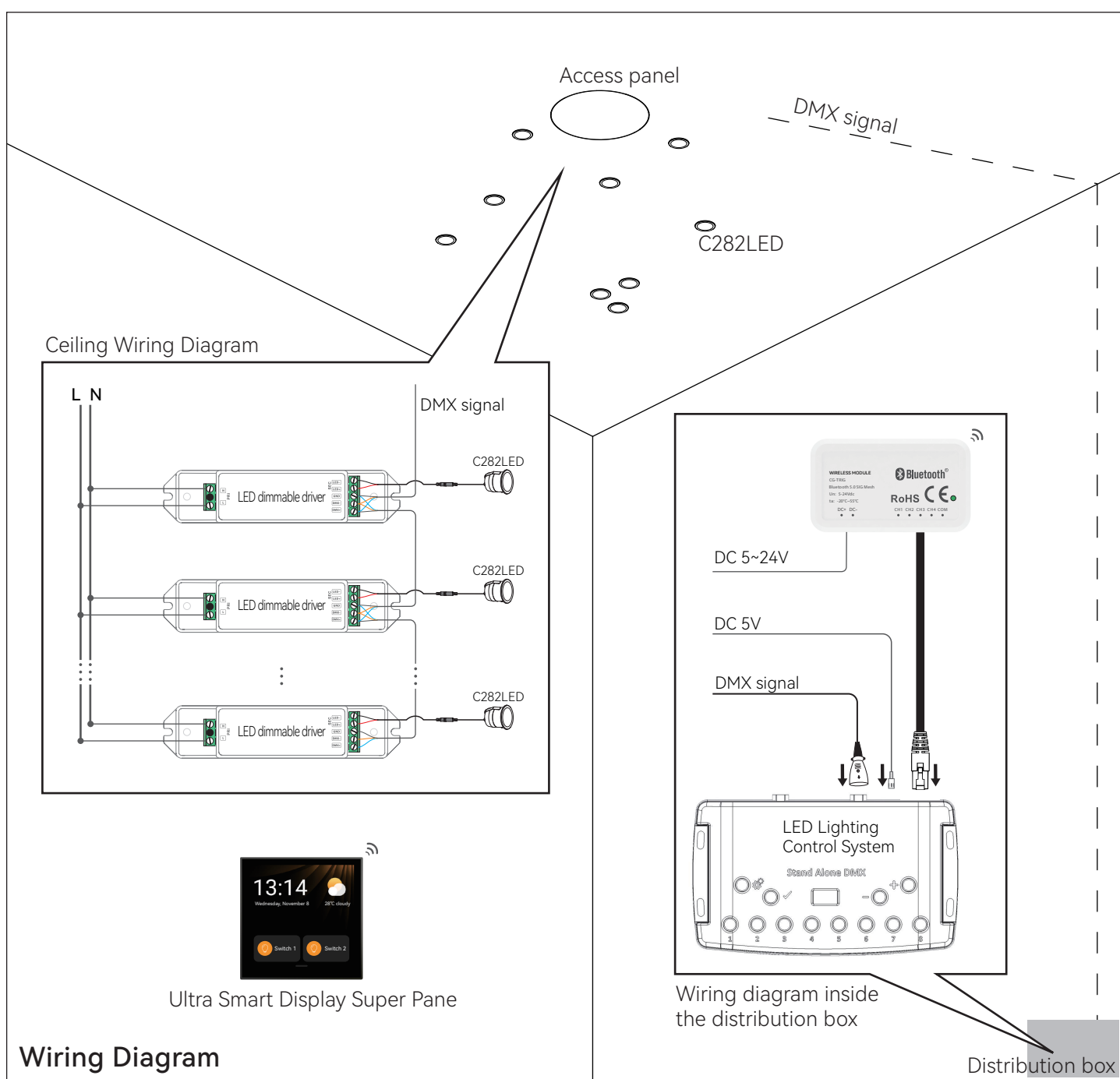
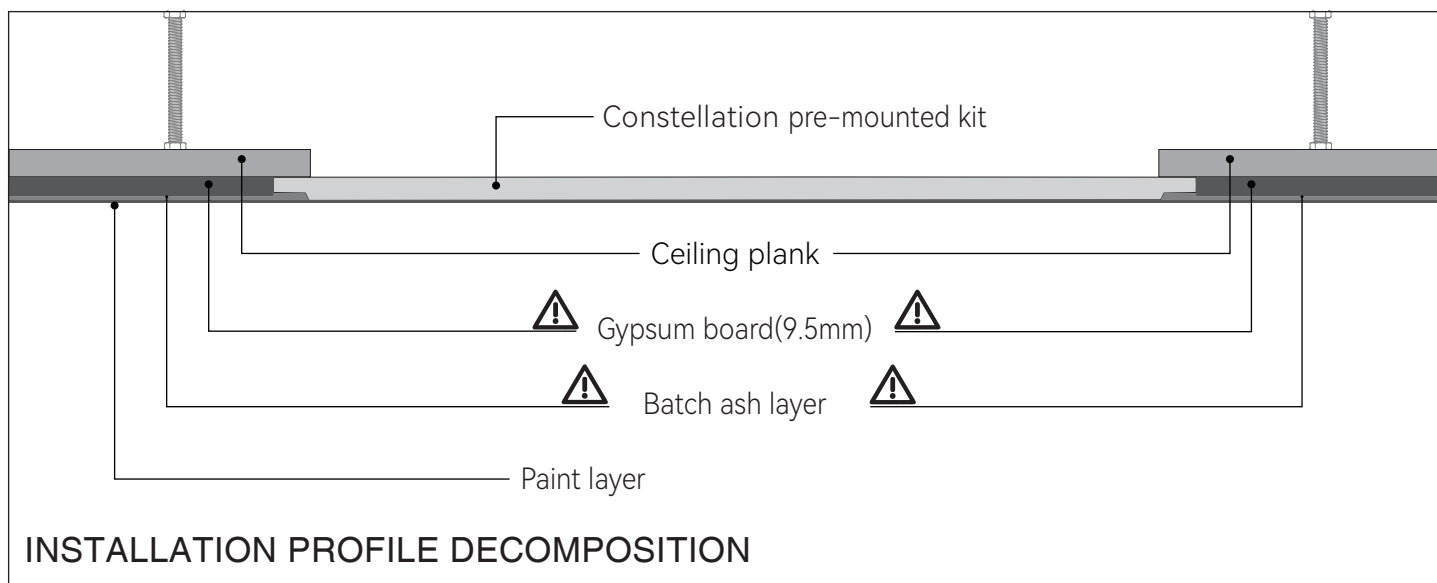

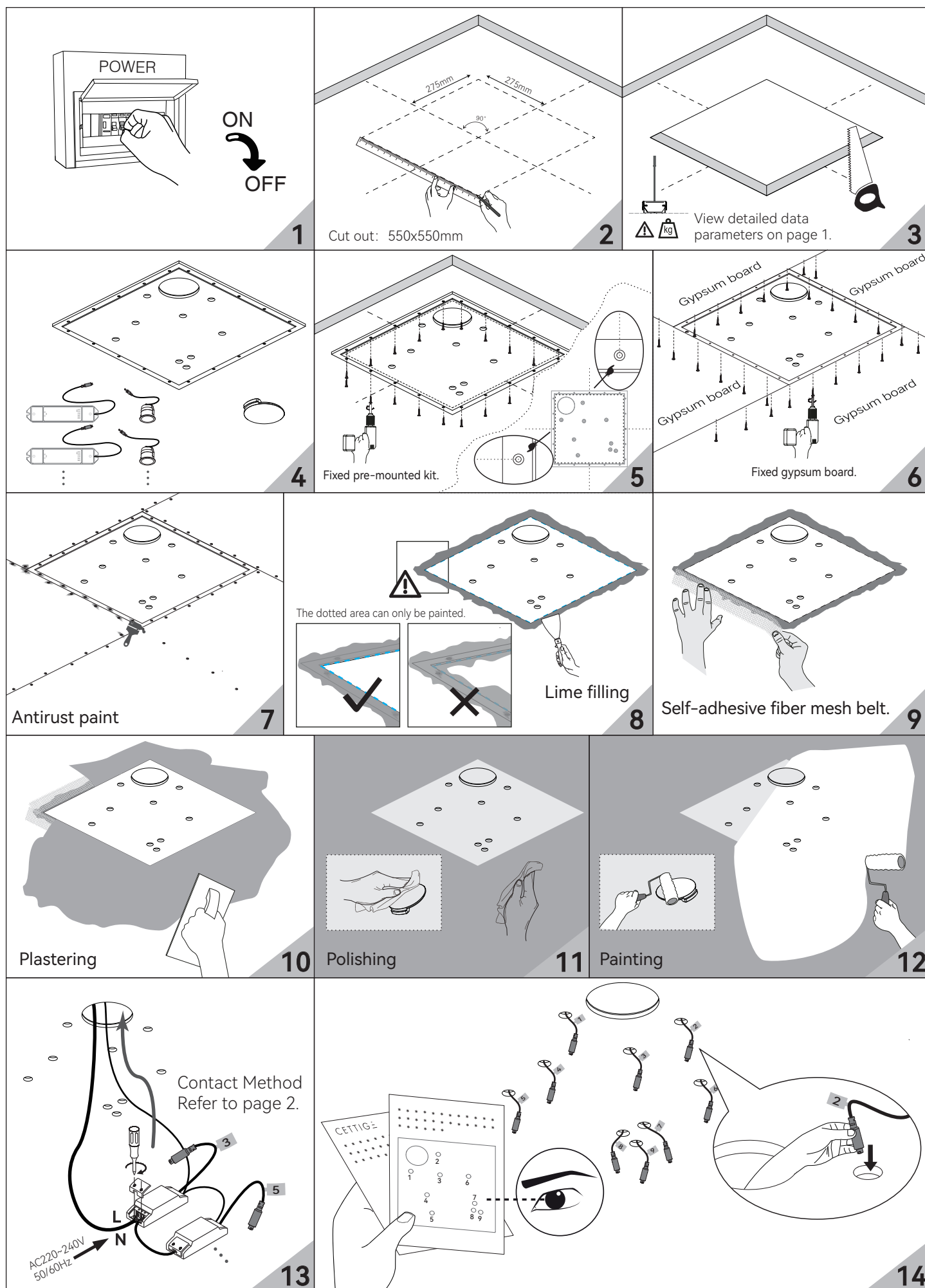

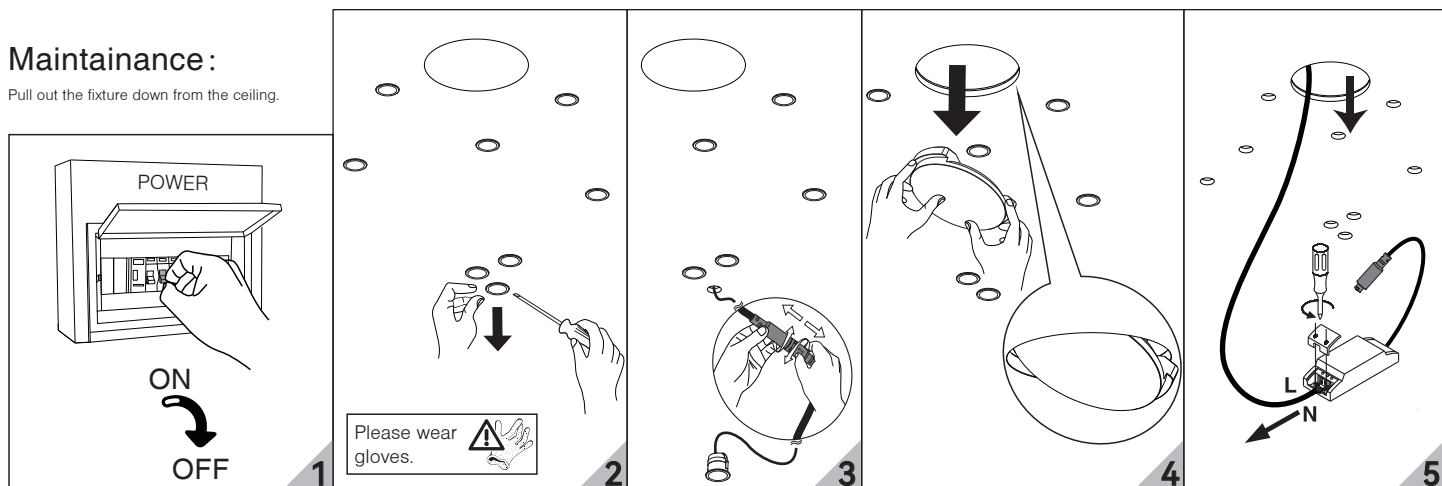
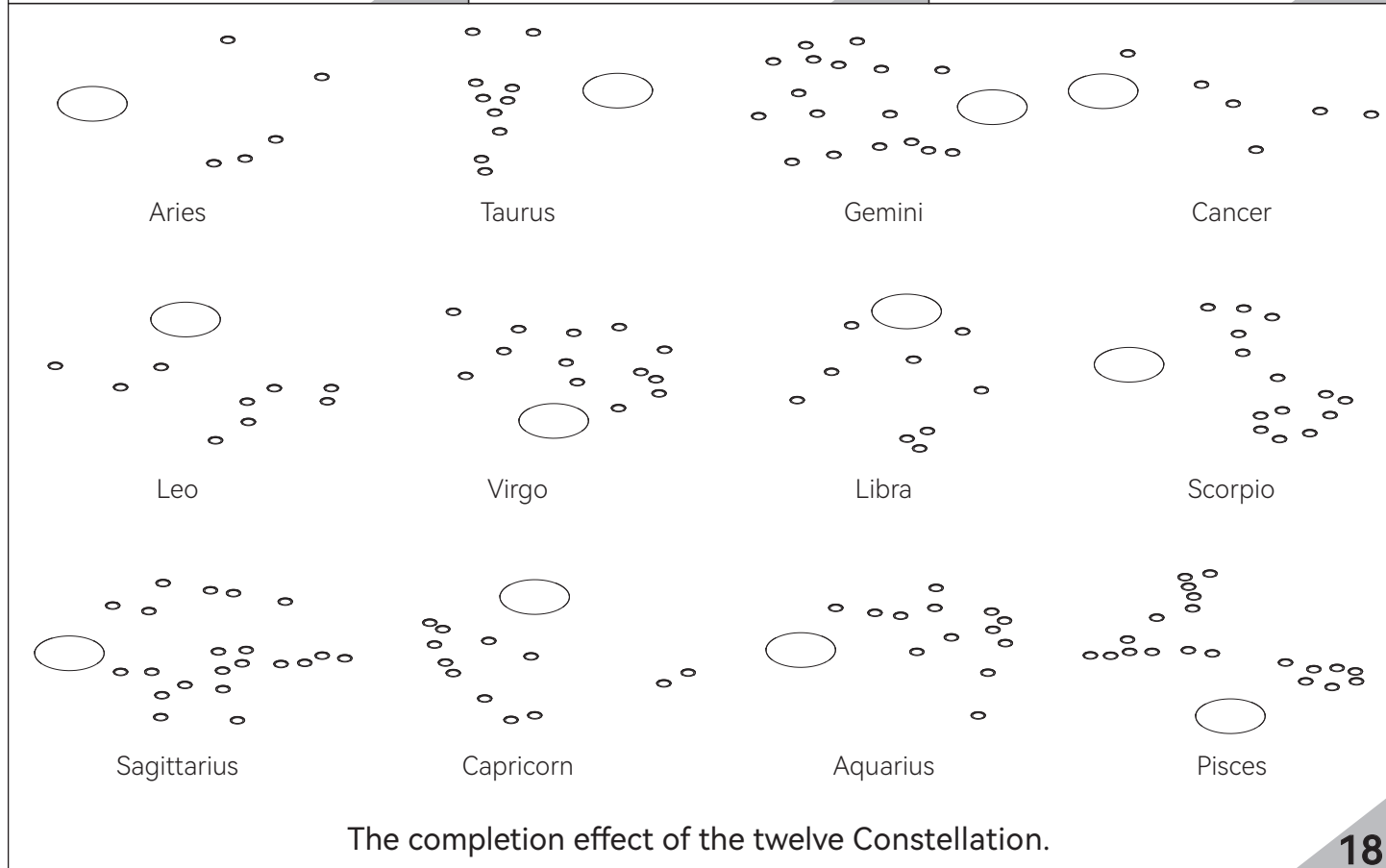
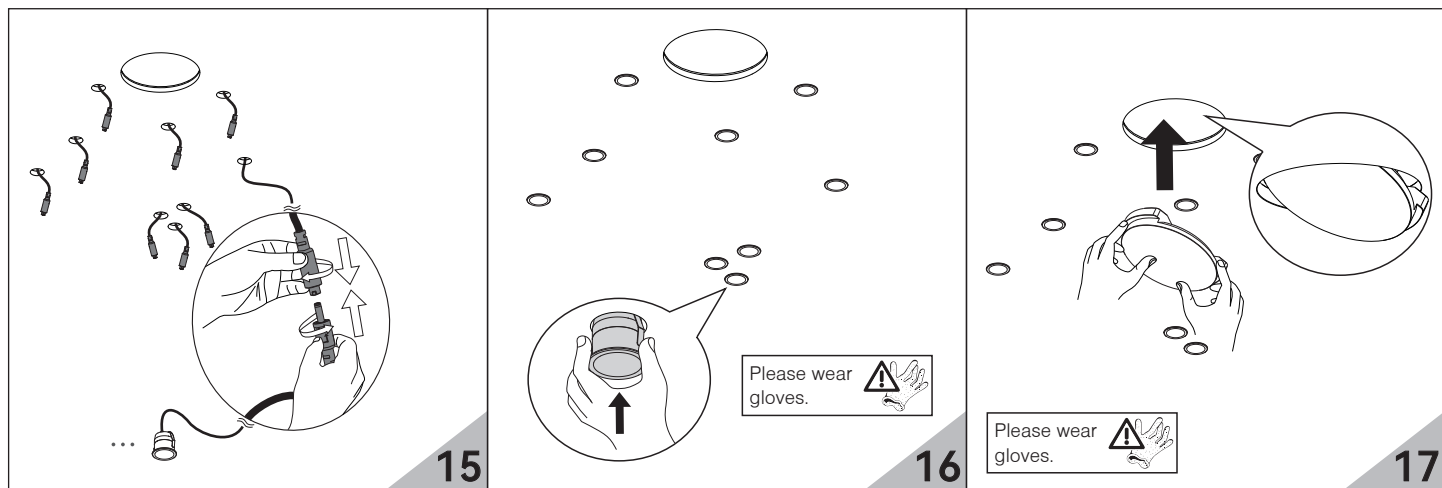

Maintenance :

Pull out the fixture down from the ceiling.

